

East Lee
County High
School
2021-2022



Jaguars

#WeAreEast
Student Handbook

SCHOOL HOURS

7:05 a.m. - 1:35 p.m.

SCHOOL COLORS

Teal, Silver and Black

SCHOOL MASCOT: JAGUARS

The jaguar is one of the three largest big cats in the world, following the lion and the tiger. It is the only one of the big cats that resides in the Americas. The jaguar represents power and strength in the pre-Columbian cultures. The Mayans believed the jaguar to be able to move between the living and the dead; the Aztecs saw the jaguar as a symbol of a ruler and a warrior.

VISION

To be a World Class provider of Academic, Career, and Technical Education

MISSION

To Provide a Relevant and Rigorous Learning Environment that Prepares ALL Students to Reach their Highest Potential

ELCHS Scholars

Own, Engage, and Represent

ALMA MATER

ALMA MATER

East Lee County we'll be true.
Success and knowledge gifts from you.
Through time our actions will reveal
Jaguars' black, silver and teal.

Throughout the halls, we will proclaim
Our alma mater's awesome name.
Lead us to victory, East Lee
We pledge our hearts to thee!

ACADEMIC AND ACADEMY PROGRAMS

AICE-Cambridge

Advanced International Certificate of Education (AICE) is a set of challenging college-level courses for high school students. It was developed by Cambridge Assessment, a department of the University of Cambridge in England. AICE was designed to give students the option to pursue a rigorous and ambitious curriculum by teaching them key skills to succeed in college-level work. At the same time, AICE classes and the diploma structure are flexible enough to let students tailor the coursework to their interests and strengths. In addition to the academic and intellectual appeal of learning in greater depth, AICE allows students the opportunity to earn an advanced diploma and college credit.

AVID

Advancement via Individual Determination (AVID), is a global nonprofit organization dedicated to closing the achievement gap by preparing all students for college and other postsecondary opportunities. Established more than 30 years ago with one teacher in one classroom, AVID today impacts more than 700,000 students in 45 states and 16 countries/territories.

College Board Advanced Placement Program

The Advanced Placement Program (AP) is a cooperative educational endeavor between high schools and colleges and universities. Since its inception in 1955, the program has provided motivated high school students the opportunity to take college-level courses in a high school setting. Students who participate in the AP Program gain college-level skills and have the opportunity to earn college credit while still in high school.

Agriculture Science Academy

The Agriculture Science Academy offers a sequence of courses that provides coherent and rigorous content aligned with challenging academic standards and relevant technical knowledge and skills needed to prepare for further education and careers in the Agriculture, Food and Natural Resources career cluster. The academy provides technical skill proficiency, and includes competency-based applied learning that contributes to the academic knowledge, higher order reasoning and problem-solving skills, work attitudes, general employability skills, technical skills, and occupation-specific skills, and knowledge of all aspects of the Agriculture, Food and Natural Resources industry.

Automotive Technology Academy

The Automotive Technology Academy coursework introduces students to the principles, theories, and concepts of Automotive Technology, and include instruction in the maintenance and light repair of Engines, Brake Systems, Electrical/Electronic Systems, Suspension, and Steering Systems, Automatic and Manual Transmission/Transaxles, and Engine Performance Systems. The instruction also includes identification and use of appropriate tools and testing/measurement equipment required to accomplish certain tasks. Program participation provides students with an understanding of soft skills and technological skills required for employment in the automotive industry. With comprehensive instruction from a knowledgeable and experienced ASE certified instructor, students also get hands on training using techniques and industry-standard tools to complete computer diagnostics. Students in this academy learn in the only professional state of the art automotive lab of its kind in the East Zone.

Criminal Justice Academy

The Criminal Justice (CJ) community has a foundation built on discipline, respect, and integrity. As future leaders, citizens will rely on law enforcement to keep our communities safe. Career ready practices are taught and reinforced in the CJ program with increasingly higher levels of complexity and expectation as a cadet advances through the program.

Digital Information Technology Academy

The Digital Information Technology Academy provides instruction with the most widely used software of Microsoft Office. Industry certification preparation occurs through the use of the online simulator GMetrix. GMetrix was founded in 2006 by a management team with over 30 years of experience in the computer and IT training industries. This program allows students to practice taking Microsoft Office Specialist certification exams. GMetrix works with partners throughout Europe, the Middle East, Asia and North and South America to provide educational tools designed to prepare individuals for the effective use of technology in the business environment. Certiport issues industry certification in the field and believes that GMetrix practice tests instill confidence and are an essential component in preparing candidates for certification. Using Gmetrix, and fulfilling the requirements regarding Gmetrix, is the greatest predictor of success on the actual exam. Students that successfully pass the certification exam earn the title of a Microsoft Specialist and have proven to possess the highly valued software skills.

Firefighting Academy

The Fire Service lives and breathes by the principles of integrity, respect, discipline, and pride. The Firefighting Academy at East Lee County High School is designed for individuals who are interested in entering the public safety fields of either firefighting or emergency medical services (EMS). Recruits who successfully meet the requirements of the academy and the Florida Bureau of Fire Standards and Training will be eligible to sit for the State of Florida Firefighter I exam. The recruits participate in activities such as fire prevention, public safety, enforcement of firefighting safety codes and standards, firefighting tactics, rescue techniques and emergency medical procedures. The ELCHS Firefighting Academy concentrates on developing its recruits' firefighting skills, positive work habits, knowledge of the fire service traditions, as well as providing emphasis on integrity, discipline, ethical character.

Hospitality Culinary Academy

The Hospitality Culinary Program is an introduction to the art of preparation, cooking, and presentation of food in the form of meals. Course material within the Hospitality is designed to teach young entrepreneurs the world of the Hospitality Industry. Students take a glimpse into the ever-evolving world of hospitality, etiquette, and the art of cooking in both commercial and residential fields. This program is geared toward students aspiring for a future in the fields of Hospitality, such as Resort & Hospitality, Hotel Management, and Culinary Arts Management. Students are given the opportunity to be officially certified in the Arts of Cooking through the ServSafe National Restaurant Association Exam. Upon receiving the certification, students are upheld and granted a higher acceptance into the hospitality career field. The qualities gained within the culinary field, not only prepare students for the Hospitality industry, but allow students to become more eloquently introduced to the characteristics of eating and preparation etiquette, cooking, and certain knowledge tasks such as cleaning and sanitization. This well-rounded Hospitality Culinary Program covers all aspects and necessities of knowledge needed for life.

Medical Academy

The Medical Academy is a three-year program which offers students the opportunity to graduate with Certified Nursing Assistant and Certified EKG Technician industry certifications. Students have the experience and certifications to immediately pursue job opportunities in hospitals, nursing homes, and medical clinics following high school graduation. While Certified Nursing Assistants and Certified EKG Technicians are entry-level medical positions, they do help give students a solid foundation to further their education to pursue more advanced medical careers, such as nurses and doctors. The Medical Academy is regulated by both the Lee County School District and the Florida Board of Nursing. Therefore, students are held to high expectations. Students are required to pass their FSA, and all classes related to obtaining their High School Diploma. Students must have a clean disciplinary record, and not have any ISS or OSS. There are also course grade requirements for each class as the student progresses through the academy. During the final year of the program, students demonstrate and practice the skills they have learned in a nursing home and hospital environment, while taking the Certified Nursing Assistant Class. Allied Health students shadow health care professionals in a healthcare setting.

TV Production Academy

The TV Production lab has been upgraded with state-of-the-art equipment. This upgrade puts ELCHS on par with other schools in the district and allows our students to work with technology and equipment they will encounter in the "real world". The goal of this academy is to get each student to excel in a chosen field, and to be comfortable with most, if not all, aspects of the field. Each student is required to appear on camera and deliver information, operate on camera, edit raw video, add graphics, produce a newscast, as well as write and produce a video feature.

Welding Academy

The Welding Technology coursework prepares students for entry into the welding industry. Students explore career opportunities and requirements of a professional welder. Content emphasizes beginning skills key to the success of working in the welding industry. Students study workplace safety and organization, basic manufacturing processes, metals identification, basic interpretation of welding symbols, and oxyfuel gas cutting practices. Students demonstrate learned skills by creating and producing a finished product. As students progress in the academy, they explore career opportunities and requirements of a professional welder. Students will emphasize learned skills and apply them to the success of working in the welding industry. Due to the steady growth in the demand for goods fabricated by welding, new welders are needed in every area of welding.

Yearbook Academy

Yearbook Academy students design and produce the East Lee County High School yearbook using industry standard computer and design programs. As a member of the yearbook staff, students capture memories that will be remembered for many years as alumni gaze at the pages of their high school yearbooks.

ATHLETICS

Mission Statement

The mission of the East Lee County High School Athletic Department is to develop, enhance, and preserve the educational values of interscholastic athletics. The department serves its athletes by providing resources to develop leadership skills, mentorship, and opportunities for personal and athletic growth. In conjunction with the Florida High School Athletic Association (FHSAA), East promotes the spirit of sportsmanship and fair play in all athletic contests and works to safeguard the physical, mental, social, and moral welfare of all high school students. At East Lee County High School, we will provide every student athlete an environment to achieve athletic success and the opportunity to utilize the formation of positive life skills

Sports Offered

Fall

Boys: Cross Country, Golf, Bowling, and Swimming
Girls: Cross Country, Golf, Bowling, Swimming, and Volleyball
Co-Ed: Cheerleading and Football

Winter

Boys: Basketball and Soccer
Girls: Basketball, Soccer, and Weightlifting
Co-Ed: Cheerleading and Wrestling

Spring

Boys: Baseball, Tennis, Track, and Weightlifting
Girls: Softball, Tennis, and Track
Co-Ed: Spring Football

Who is a Student Athlete?

A student athlete is someone who understands how to manage school and sports by providing equal dedication and maximum effort to both areas. Student athletes must maintain a minimum of a 2.0 GPA in order to participate in high school sports. Jaguar athletes represent the team, the school, and the LCAC (Lee County Athletic Conference)

Student athletes are often challenged to balance academics, community service and sportsmanship during the school year. At times, these tasks can be quite overwhelming. It is important for student athletes to understand that they are a student, first. Students must learn to properly manage time and put in maximum effort, and achieving great things is always possible.

Tips for being a Jaguar Student Athlete at East

- Set attainable goals for yourself
- Prioritize your tasks and celebrate when they are completed
- Manage your time
- Create a positive work ethic for every subject
- Communicate with your teachers, coaches and teammates
- Enjoy what you're doing and everything will fall into place.

NCAA Eligibility

The advantages of competing in college sports are both immediate and lifelong. Participating in college sports provides opportunities to learn, compete and succeed. Student-athletes as a group graduate at higher rates than their peers in the general student body and feel better prepared for life after college. College-bound student-athletes preparing to enroll in a Division I or Division II school need to register with the NCAA Eligibility Center to ensure they have met amateurism standards and are academically prepared for college coursework. For more information go to: <http://www.ncaa.org/student-athletes/play-division-i-sports>

ATTENDANCE: Regular school attendance is very important to a student's academic success. Students are expected to be in school except in cases of emergency or for reasons outlined below:

1. Personal illness (medical evidence may be requested)
2. Death of a relative
3. Religious holiday(s) of the specific faith of the student
4. Subpoena by any law enforcement agency
5. School Sponsored Activities

Other absences must be excused by the administration prior to the absence. Students who are absent from class without permission will be referred to the appropriate school administrator.

Note: Any student participating in an after-school activity or athletic event must be in school on the day of or the day before (if it is a weekend event) the activity for a MINIMUM of two (2) blocks plus lunch. Those students who are suspended from school attendance are prohibited from participating in and/or attending any after-school activities at any Lee County School during suspension.

Documentation Required After an Absence

When a student returns to school following an absence, he/she is **expected to bring a written note** from a parent/guardian explaining the absence. A note from a physician may be required for students with extended absences. Students who fail to bring a note within one week will have the absence recorded as an unexcused absence. Unexcused absences may impact student credit and may result in loss of a driver's license, per state statute. Trips or extended absences must be pre-arranged with the approval of an administrator. In the case of an emergency that requires a student to be tardy to school or be dismissed early, written documentation is required from the parent/guardian. This documentation will be verified by a phone call to the parent/guardian prior to releasing any student from school.

Make-up Work

It is the student's responsibility to request all make-up work immediately upon return to school from an absence. The student shall be given the **number of days missed plus one additional day** to submit the makeup work for full credit.

Tardiness

ELCHS Campus opens at 6:40AM for student drop off. Students are required to be in class by 7:05 a.m. Students in the building but NOT in class After 7:05, will be issued a tardy slip/lunch detention. Students entering the building after 7:05 will enter the front office and will be issued a tardy slip/lunch detention by office staff. Excessive tardiness to school and/or class will result in further discipline consequences.

The following reasons will be considered **excused**:

- Personal illness
- Illness in the immediate family
- Bus breakdown or accident
- Extremely bad weather
- Involvement in an auto accident
- Emergency at home (validity determined by administration)
- Medical appointment
- Religious ceremony
- Court Appointments

Every School Day Counts....

1 or 2 days a week doesn't seem like much but...

If your child misses...	That equals...	Which is...	And over 13 years of schooling that's...
1 day every 2 weeks	20 days per year	4 weeks per year	Nearly 1 ½ years
1 day per week	40 days per year	8 weeks per year	Over 2 ½ years of school
2 days per week	80 days per year	16 weeks per year	Over 5 years
3 days per week	120 days per year	24 weeks per year	Nearly 8 years

How about 10 minutes late a day? Surely that won't affect my child?

He/she is only missing just...	That equals...	Which is...	And over 13 years of schooling that's...
10 mins per day	50 mins per week	Nearly 1 ½ weeks per year	Nearly ½ year
20 mins per day	1 hr. 40 mins per week	Over 2 ½ weeks per year	Nearly 1 year
30 mins per day	Half a day per week	4 weeks per year	Nearly 1 ¼ years
1 hour per day	1 day per week	8 weeks per year	Over 2 ½ years

EVERY DAY COUNTS

If you want your child to be successful at school then, **YES, attendance does matter!**

AUDITORIUM

Appropriate behavior must be exhibited at all times. Food, beverages and gum are prohibited. Students are prohibited from standing on seats, draping their legs over seats, or placing their feet on the backs of seats. When entering the auditorium, students are expected to enter in an orderly manner, fill the seats from the front to the rear, and all seats between students. The audience is expected to give full attention to the performers/speakers and show appropriate appreciation and respect.

BACKPACKS/BAGS

ELCHS students are allowed to bring backpacks and bags to school to carry their Chromebook and school supplies. Upon entry into each classroom, students must retrieve all items needed for the class period from their backpack or bag. Backpacks/Bags will then be placed in a designated area within the classroom away from traffic and separated from each other. Students will only be allowed to go back into their backpack or bag with teacher permission and supervision.

BUS REGULATIONS

Riding the school bus is a privilege. Students must obey the driver who is in charge of the bus. Students must remain in assigned seats and keep their arms and heads inside the bus at all times. Food, drink, tobacco products, and chewing gum are prohibited on the bus. Fighting, profanity, abusive language, large or sharp objects, fireworks, balls, bats, skateboards, radios, tape players, animals, and glass containers are prohibited. Only regularly scheduled students are to ride the school bus.

CAFETERIA/LUNCH

In order to accelerate the meal checkout process and restrict unauthorized access to student lunchroom accounts, students must state their full name and student ID number for each cafeteria transaction. Student behavior in the cafeteria is expected to exemplify standards of courtesy and cleanliness. Students are to remain seated in assigned seats at all times. When finished eating and before leaving the cafeteria, students are expected to remove trays, food and beverages, and packaging from tables and properly deposit the items in appropriate trash and recycling receptacles. Cutting in line, failing to remove trays or litter from tables and throwing food will result in disciplinary action.

COLLEGE AND CAREER INFORMATION

Students who have questions about postsecondary and career opportunities should see the College and Career Specialist, in room 1018 in the main office, for career counseling, interest surveys, scholarship information, financial aid options, ACT/SAT waivers/registration, and information on colleges and job availability. The College and Career Lab is open every school day from 8:30am-4:00pm.

CELL PHONES AND ELECTRONIC DEVICES

At East Lee County High School cell phones are permitted in the hallways between classes and in the cafeteria. Students may only use their cell phones in the classroom as part of an instructional lesson sanctioned by the teacher. Students using their cell phones inappropriately will be disciplined per the district Code of Conduct. For the safety of students and staff members, students may only wear earbuds or over-the-ear headphones in the classroom when participating in a teacher directed activity. Earbuds and over-the-ear headphones are permitted in the cafeteria. For the safety of students and staff members, while in the cafeteria, students may only wear one earbud and over-the-ear headphones must be worn so that one ear remains uncovered.

If students bring electronic devices on campus, they are responsible for them at all times. Students are responsible for electronic devices that are lost or stolen at school. Incidents involving the theft or loss of electronic devices will be reported directly to the School Resource Officer for investigation.

CHROMEBOOKS

Students are issued Chromebook devices to be used as an integral part of their learning experience. Teachers will review the responsibilities of Chromebook usage when they report to class, and parents will be required to sign a Chromebook agreement. All students will be required to have earbuds with them for use with the Chromebooks when the lesson requires audio support.

CLOSED CAMPUS

East Lee County High School is a closed campus. Students must remain on campus from the time they arrive until school is officially dismissed.

CODE OF STUDENT CONDUCT AND PARENT GUIDE

East Lee County High is committed to improved student achievement so that all students meet or exceed rigorous standards. With this in mind, ELCHS follows the Code of Conduct for Students developed by the School District of Lee County to clearly communicate the behavioral expectations necessary for maintaining a safe and orderly learning environment.

The Code of Conduct for Students applies to all students enrolled at ELCHS.

Students enrolled at ELCHS are subject to the law, rules, regulations, and policies of the State of Florida and the School Board of Lee County, Florida, anytime:

1. a student is on School Board-owned property;
2. a student is attending school;
3. a student is presumed by law to be attending school;
4. a student is being transported to or from school or school-sponsored events at public or school expense; and
5. a student attends or participates in a school-sponsored activity.

All students are subject to the immediate control and direction of teachers, staff members, or bus drivers to whom such responsibility has been assigned by the principal or the principal's designee. (Section 1003.31, Florida Statutes) It is beyond the scope of this conduct book to identify all potentially relevant State laws, rules or regulations, and School Board policies that may apply to a specific disciplinary case. This document can be accessed online at www.leeschools.net/code-of-conduct.

DELIVERIES

The school is unable to accept deliveries for students during the school day. Should a delivery arrive, it will be refused and sent back. This includes but is not limited to flowers, food, balloons and stuffed animals.

DIPLOMA OPTIONS

Standard Diploma Option

A Standard Diploma will be awarded when students have successfully completed the graduation requirements, as specified in §1003.4282 F.S. and as set forth in the District's Student Progression Plan. See the state graduation requirement document at the end of this handbook. In order to earn a Standard Diploma a student must:

- Earn an overall unweighted 2.0 grade point average (GPA) on a 4.0 scale.
- Earn a passing score on the statewide, standardized Reading assessment or passing scores on a standardized test (SAT/ACT) that are concordant with passing scores on the statewide, standardized assessment.
- Earn a passing score on the Algebra 1 end-of-course assessment.
- Earn a passing score on the English Language Arts portion of the statewide, standardized assessment or passing scores on a standardized test (SAT/ACT) that are concordant with passing scores on the statewide, standardized assessment.

Standard Diploma Options for Students with Disabilities

Students eligible for and officially placed in an exceptional student education (ESE) program may work towards one of three Standard Diploma options:

- The Standard Diploma;
- Standard Diploma with mastery of academic and employment competencies;
- Standard Diploma for Students with Significant Cognitive Disabilities working toward mastery of the Florida Standards Access Points.

According to §1003.4282, F.S., the IEP team may waive the online course requirement as well as the statewide, standardized assessment and/or end-of-course (EOC) requirement for graduation with a standard diploma. To be considered for the assessment waiver, students must have met all of the following criteria:

- Been identified as a student with a disability with a current Individual Education Plan. As specified in §1007.02(2), F.S., students with disabilities include students with intellectual disabilities, hearing or visual impairment, speech or language impairment, emotional / behavioral disorders, orthopedic impairment, other health impairment, autism spectrum disorder, traumatic brain injury or a specific learning disability.
- Have taken the statewide, standardized assessment with appropriate, allowable accommodations at least once.
- Have demonstrated the knowledge, skills and abilities required by grade appropriate Next Generation Sunshine State Standards and/or the Florida Standards for College and Career Readiness as appropriate.
- Have been determined (by the IEP team) that the statewide, standardized assessment or end-of-course assessment (EOC) cannot accurately measure the student's abilities, even if all appropriate, allowable testing accommodations are used. If there is sufficient evidence that the student has mastered the applicable course content or Next Generation Sunshine State Standards and/or the Florida Standards for College and Career Readiness, the statewide, standardized assessment and/or end-of-course assessment (EOC) requirement may be waived.

DISCIPLINE

The purpose of any discipline consequence is to change behavior, help in the development of self-control, and promote responsible behavior and good citizenship. Students at East Lee County High School are expected to conduct themselves in a responsible manner that will bring credit to themselves and the school.

Infractions of rules shall result in discipline by the individual teachers and/or the administration, including all those designated by the principal to administer discipline. Discipline will be administered according to the School District of Lee County Discipline Policy.

It is the responsibility of each East Lee County student to become familiar with the District Code of Student Conduct. It is important to note that, subject to laws and rules of the state board and the District, the principal or his or her designee has the authority to take additional or more severe action when, in his or her opinion, the nature of the offense warrants it.

AUTHORITY OF SCHOOL PERSONNEL

The principal or principal designee has the unequivocal right to determine the appropriate charge(s) for the misconduct and the corresponding level of the offense based on the facts and circumstances of the incident(s). Teachers and other school staff members have authority for the control and discipline of students assigned to them on campus, as well as in other places where they may supervise students. Students are expected and required to follow the requests and directives of all teachers and school staff members, school volunteers, and chaperones when on School Board

owned property or at other places where they are under the direct supervision of School Board personnel. Teachers shall make every reasonable effort to control classroom disruptions or misbehavior by students. However, if a disruption or misbehavior persists, or if the disruption is severe, the teacher shall direct the student to an appropriate administrator with a description of the incident on a referral form provided by the administration. (1003.32, Florida Statutes) Students may be subject to discipline for violation of the code even if that conduct occurs on property not owned or controlled by the Board, but that is connected to activities or incidents that have occurred on property owned or controlled by the Board, or conduct that, regardless of where it occurs, is directed at a Board official or employee, or the property of such official or employee.

Lunch Detentions

Lunch detentions may be issued for minor infractions of the rules. Lunch detentions are held during the student's lunch shift. Students must get their lunch and report immediately to the lunch detention room.

After-Hours School

After-Hours School (AHS) may be issued by an administrator. AHS is held one day a week. Failure to attend AHS, when assigned, will result in a more serious discipline consequence. Students will be given at least 24 hours' notice for an After-Hours School assignment so that transportation can be arranged.

External Suspension involves a student being sent home for up to ten days in length. Students who are suspended from school are prohibited from visiting any Lee County campus, including after-school activities and evening events.

Internal Suspension (Transition Room) involves a student completing class assignments in the Transition room. Normal school day privileges are denied to students who are assigned to Internal Suspension (ISS). ISS may be for a period, several periods, an entire day or for several days.

STUDENT DRESS CODE

The purpose of a dress code is to provide guidance to students and parents as to appropriate attire for school and all school functions. In addition, the dress code is a primary means of helping students learn a skill, which is required for success in getting and keeping employment. As adults, we know that there is a difference between dressing for our jobs and dressing for recreation; therefore, having students practice this distinction while at East is a way to promote long-term success. Our guiding principles for the dress code are based on clothing that avoids distracting from the learning environment, disrupting school activities, or creating a safety hazard.

1. Facial masks covering the nose and mouth are required unless a parent has completed the opt out form. All masks must comply with the school dress code guidelines listed below.
2. Pants with holes and rips are prohibited.
3. Leggings and yoga pants, with or without pockets, may only be worn with a shirt or top that is fingertip length.
4. For the safety of students and staff members, students may wear ear buds or over-the-ear headphones in the classroom only when participating in a teacher directed activity, or when in the cafeteria and hallways. For the safety of students and staff members, while in the cafeteria and hallways, students may only wear one ear bud and over-the-ear headphones must be worn so that one ear remains uncovered.
5. Students must remove hats and/or other head coverings, including hoods (hooded sweatshirts/jackets worn up), handkerchiefs, durags, bandanas, bonnets, shower caps, sunglasses, full-faced masks, face paint, or other disguises that may inhibit the identification of the individual when they enter the building and throughout the entire school day. An administrator must approve any head coverings worn for religious significance or medical reasons.
6. Pajama attire of any kind, including bedroom slippers or house shoes, is prohibited. Blankets and Snuggles are prohibited.
7. Apparel shall be adequate in both length and coverage to be considered appropriate for school. Skirts and shorts are to be **no more than two inches above the knee**.
8. Pants shall be worn fastened and at the waist. It is unacceptable for undergarments to be exposed. Sagging pants are prohibited.

9. Shirts or tops shall be appropriately fastened in accordance with the design of that shirt or blouse. The length shall extend beyond the waist.
10. Outfits that provide minimum coverage are prohibited. Examples include: transparent, strapless, off-the-shoulder, low-cut, halters, backless dresses or tops, tube tops, tank tops, spaghetti straps, and muscle shirts. Shirts with sleeves must be worn under sleeveless jerseys.
11. Any articles of clothing or jewelry that could likely cause injury are prohibited. Wallet chains of any length are prohibited.
12. Apparel or symbols which may be gang-related may not be displayed on a student's person or in the student's possession, vehicle or other locations on campus.
13. Gang-related tattoos, or other tattoos that may cause a substantial disruption to the educational environment, as determined by the principal are prohibited.
14. Shoes shall be worn at all times.
15. Long/oversized coats, jackets, or jerseys are prohibited.
16. Apparel, emblems, insignias, badges, or symbols that promote the use of alcohol, drugs, tobacco, violence, sex, or any other illegal activity are prohibited.
17. Hair styles that may cause a substantial disruption to the educational environment, as determined by the administration, are prohibited.

Note: The school administration reserves the right to appraise current fashion or Fad and determine whether it is appropriate for school. Students must be in dress code compliance when entering school grounds, during all after-school events, and at all times while students are on campus. Dress code will be checked daily and strongly enforced.

DUAL ENROLLMENT

Dual Enrollment is a program that allows high school students to simultaneously earn college credit while also earning high school credit. These courses and the required textbooks are funded by the school district. Upon graduation from high school, the college credits earned may be transferred to any public Florida colleges/universities and many out of state universities.

Eligibility Requirements and Credit Options:

- Second semester freshmen and sophomore students who have an unweighted GPA of 3.5 may take six (6) college credits per term.
- Juniors and seniors who have an unweighted GPA of 3.0 may take 11 credits per term. Students must also pass the ACT or SAT. Students should see their counselor for score requirement

Career and Technical Dual Enrollment

Fort Myers Technical College and Cape Coral Technical College provide advanced instruction for high school students who demonstrate an interest and readiness to engage in postsecondary certificate career prep courses. The technical colleges offer high school students who qualify for dual enrollment an opportunity to earn credit toward both a high school diploma and a post-secondary career preparatory certificate. Elective credits based on a wide variety of Career and Technical program choices are available.

FIELD TRIP/EXTRACURRICULAR ACTIVITY

Participation in a school-sponsored extracurricular activity is a privilege. These activities are important components of our total educational program. The School District of Lee County expects a higher standard of excellence from students involved in these activities. Participating students are representing our school, community, state and often our nation. The standard of behavior should be one that exhibits pride, politeness, and responsibility. All students participating in field trips and extracurricular activities must comply with the conduct required by the Code of Conduct for Students. Students must also meet the requirements stated below:

- Students must have at least a “C” in all courses missed on the day of the field trip and in the course/class sponsoring a field trip.
- Student must have the parent permission form signed and returned on the designated due date. ● Students assigned External or Internal Suspension on the day of the extracurricular activity or field trip will be unable to participate.
- Students must have fewer than five (5) unexcused absences in the quarter the activity takes place. ● Students must resolve fees, fines, or overdue books within the School District of Lee County in order to purchase a dance ticket.

The administration has the right to deny a student participation in an activity based on attendance and discipline reports.

FEES AND FINES

Students must have a zero balance for all fees and fines to participate in some special extracurricular activities or privileges. Students must see the school bookkeeper to reconcile any outstanding balance.

FLORIDA BRIGHT FUTURES SCHOLARSHIP PROGRAM

The Florida Bright Futures Scholarship Program establishes a lottery-funded scholarship to reward Florida high school graduates who merit recognition of high academic achievement and who enroll in an eligible Florida public or private post-secondary educational institution within the specified timeframe after high school graduation. The Florida Bright Futures Scholarship Program is the umbrella program for the Florida Academic Scholars Award, the Florida Medallion Scholars Award, and the Florida Gold Seal Vocational Scholars Award. Seniors who apply for the Bright Future Scholarship will officially be evaluated twice during their senior year, in early spring and following graduation. Seniors will receive an email from Bright Futures of their status following each evaluation. As changes in legislation may occur with each session, the most current information can be found at www.FloridaStudentFinancialAid.org. There are four scholarship award levels seniors can qualify for: Florida Academic Scholars Award, Florida Medallion Scholars Award, Florida Gold Seal Scholars Award, and the Gold Seal CAPE Scholars Award. A student may qualify for all four award levels but may only receive the highest one earned. Each scholarship program has specific criteria that must be met. These requirements are subject to change with each legislative session. The general eligibility requirements for an initial award from any of the four scholarships include:

- Be a Florida resident
- Complete a Florida Financial Aid Application online at www.FloridaStudentFinancialAid.org by the end of the second semester of the student's senior year
- Earn a Florida standard high school diploma, or its equivalent
- Be accepted by, and enrolled in, an eligible Florida public or independent post-secondary education institution AND enroll in a post-secondary institution in Florida for at least six semester credit hours, or the equivalent each semester
- Not have been found guilty of, or have pled nolo contendere to, a felony charge

Florida Academic Scholars Award requires:

- 3.5 weighted GPA in the 16 credits identified by the Florida Board of Regents as college-preparatory courses to meet graduation requirements to include 4 English, 4 Math (Algebra 1 and above), 3 Science, 3 Social Studies, and 2 Foreign Language (must be the same language, 2 consecutive years)
- SAT score of 1290 or higher or ACT score of 29 or higher
- 100 hours of documented community service

Florida Medallion Scholars Award requires:

- 3.0 weighted GPA in the 16 credits identified by the Florida Board of Regents as college-preparatory courses to meet graduation requirements to include 4 English, 4 Math (Algebra 1 and above), 3 Science, 3 Social Studies, and 2 Foreign Language (must be the same language, 2 consecutive years)
- SAT score of 1170 or higher or ACT score of 26
- 75 hours of documented community service

Florida Gold Seal CAPE Scholars Award requires:

- 5 postsecondary credit hours through CAPE industry certifications which articulate for college credit
- 30 hours of documented community service

The Florida Gold Seal Vocational Scholars Award requires:

- 3.0 weighted GPA in the 16 specific courses to include 4 English, 4 Mathematics (any math credits), 3 Science, 3 Social Studies, 1 Practical or Performing Art, ½ Personal Fitness, and ½ PE
- 3.5 un-weighted GPA in required 3 vocational courses in the same program
- 30 hours of documented community service
- The following minimum scores on one of the following tests:

ACT	SAT	PERT
Reading: 19	Verbal: 440	Reading: 106
English: 17	Math: 440	Writing: 103
Math: 19		Math: 114

FOCUS PARENT ACCOUNTS

PERSONAL | PASSIONATE | PROGRESSIVE

STAY CONNECTED THROUGH FOCUS PARENT PORTAL



Lee County's **FOCUS Parent Portal** provides parents/guardians a real-time view of their child's assignment grades, attendance information, current grade averages in all classes, as well as progress monitoring results.



HOW TO REGISTER

- ▶ <https://lee.focusschoolsoftware.com/focus/>
- ▶ If you are creating an account for the first time, select the **"Click here to create a Focus Parent Portal Account"** link at the center of the page.
- ▶ Select the **"CREATE ACCOUNT"** icon on the bottom of the page.
- ▶ Enter the information in all the required fields and click **"Submit"** to create your account.
- ▶ Once all required information has been entered click **"I would like to ADD A CHILD who is already enrolled"**.
- ▶ You will need a Student ID, Birth Date, and Portal PIN for each student account you wish to add.
- ▶ Note that the student Portal PIN will be emailed to the Parent's email address on file. If you did not receive this PIN, contact your child's school.
- ▶ Enter the information in all the required fields and click **"Add Student"** to create your account.
- ▶ Your student's account is now linked to your parent portal account.
- ▶ To add another child, click **I would like to ADD A CHILD who is already enrolled.** Enter all the information required and click **Add Student**. (Note that this step can be completed as many times as necessary, or later, if needed).
- ▶ Otherwise, click **"I am Finished Adding Students. Please take me to the Portal"**

***Note in the future you will need to use the username provided, and the password you create to access your portal again.*

239.334.1102 | www.leeschools.net | 2855 Colonial Boulevard, Fort Myers, FL 33966





MANTÉNGASE CONECTADO A TRAVÉS DEL PORTAL PARA PADRES 'FOCUS'

El Portal para Padres FOCUS del Condado de Lee ofrece a los padres/tutores una visión al momento actual (tiempo real) de las calificaciones de las tareas de sus hijos, información sobre asistencia, los promedios de calificaciones en todas las clases, así como resultados de monitoreo de progreso académico.



CÓMO REGISTRARSE

- ▶ <https://lee.focusschoolsoftware.com/focus/>
- ▶ Si está creando una cuenta por primera vez, seleccione el enlace, haga "clic" aquí para crear una Cuenta de Focus Portal para Padres/ "Focus Parent Portal" en el centro de la página.
- ▶ Seleccione el icono "CREAR CUENTA" (CREATE ACCOUNT) en la parte inferior de la página.
- ▶ Ingrese la información en todos los campos obligatorios y haga "clic" en "Enviar" (submit) para crear su cuenta.
- ▶ Una vez que haya ingresado toda la información requerida, haga "clic" en "Me gustaría AGREGAR UN NIÑO/ (ADD A CHILD) que ya está inscrito".
- ▶ Necesitará una identificación del Estudiante, Fecha de Nacimiento y el "PIN" (Número de Identificación Personal) del portal para cada cuenta de estudiante que desee agregar.
- ▶ Tenga en cuenta que el "PIN" del portal del estudiante se enviará por correo electrónico a la dirección de correo electrónico de los padres que tenemos en el archivo. Si no recibió este "PIN," comuníquese con la escuela de su hijo.
- ▶ Ingrese la información en todos los campos obligatorios y haga "clic" en "AGREGAR UN ESTUDIANTE" (add student) para crear su cuenta.
- ▶ La cuenta de su estudiante ahora está vinculada/conectada a su Cuenta del Portal para Padres.
- ▶ Para agregar otro niño/a, haga "clic" en "Me gustaría AGREGAR UN NIÑO (ADD A CHILD) que ya está inscrito." Ingrese toda la información requerida y haga "clic" en Agregar estudiante. (Tenga en cuenta que este paso se puede completar tantas veces como sea necesario, o más tarde, si es necesario.)
- ▶ De lo contrario, haga "clic" en "He terminado de agregar estudiantes. Por favor, lléveme al portal."

***Tenga en cuenta que eventualmente deberá utilizar el nombre de usuario (usuario) que se proveyó y la contraseña que creó para poder tener acceso a su portal nuevamente.*

GRADING SCALE

- A Outstanding progress 90-100%
- B Above average progress 80-89%
- C Average progress 70-79%
- D Lowest acceptable progress 60-69%
- F Failure 0-59%

Weighted Grading System

The weighted credit is the same for all courses designated to be given weighted credit and is calculated as follows:
Honors classes and Level 3 and above classes:

- ½ credit (semester) = .02 weighted credit
- 1 credit (year) = .04 weighted credit

Advanced Placement, Cambridge International Diploma Program (AICE), International Baccalaureate and Dual Enrollment Classes:

- ½ credit (semester) = .04 weighted credit
- 1 credit (year) = .08 weighted credit

GRADUATION REQUIREMENTS

Standard Diploma Requirements
Academic Advisement – What Students and Parents Need to Know

What are the diploma options?
Students must successfully complete one of the following diploma options:

- 24-credit standard diploma
- 18-credit Academically Challenging Curriculum to Enhance Learning (ACCEL)
- Career and Technical Education (CTE) Pathway
- Advanced International Certificate of Education (AICE) curriculum
- International Baccalaureate (IB) Diploma curriculum

What are the state assessment requirements?
Students must pass the following statewide assessments:

- Grade 10 English Language Arts (ELA) at a concordant score
- Algebra 1 end of course (EOC) at a concordant score

Refer to [Graduation Requirements for Florida's Standards Assessments](#) for concordant and comparative scores.

Students enrolled in the following courses must participate in the corresponding EOC assessment, which constitutes 20 percent of the final course grade**:

- Algebra 1
- Geometry
- Biology I
- U.S. History

**Special note: Thirty percent not applicable if not enrolled in the course but passed the EOC (credit acceleration program (CAP)).

What is the difference between the 18-credit ACCEL option and the 24-credit option?

- 3 elective credits instead of 6
- Physical Education is not required
- Online course is not required

What is the difference between the CTE Pathway option and the 24-credit option?

- At least 18 credits are required
- 4 elective credits instead of 6
 - 2 credits in CTE courses, must result in program completion and industry certification
 - 2 credits in work-based learning programs or up to 2 elective credits, including financial literacy
- Physical Education is not required
- Fine and Performing Arts, Speech and Debate or Practical Arts is not required
- Online course is not required

24-Credit Standard Diploma

4 Credits ELA

- ELA 1, 2, 3, 4
- ELA honors, Advanced Placement (AP), AICE, IB and dual enrollment courses may satisfy this requirement.

4 Credits Mathematics*

- One of which must be Algebra 1 and one of which must be Geometry
- Industry Certifications that lead to college credit may substitute for up to two mathematics credits (except for Algebra 1 and Geometry)
- An identified computer science** credit may substitute for up to one mathematics credit (except for Algebra 1 and Geometry)

3 Credits Science

- One of which must be Biology I, two of which must be equally rigorous science courses
- Two of the three required course credits must have a laboratory component
- Industry Certifications that lead to college credit may substitute for up to one science credit (except for Biology I)
- An identified computer science** course may substitute for up to one science credit (except for Biology I)

3 Credits Social Studies

- 1 credit in World History
- 1 credit in U.S. History
- 0.5 credit in U.S. Government
- 0.5 credit in Economics

1 Credit Fine and Performing Arts, Speech and Debate, or Practical Arts*

1 Credit Physical Education*

- To include the integration of health

8 Elective Credits

1 Online Course

- Students must meet the state assessment requirements.
- Students must earn a 2.5 grade-point average (GPA) on a 4.0 scale for all cohort years.

* Elective courses are specified in the [Florida Course Code Directory](#).
**A computer science credit may not be used to substitute for both a mathematics and science credit.

<p>Scholar Diploma Designation</p> <p>In addition to meeting the 24-credit standard high school diploma requirements, a student must meet all of the following requirements:</p> <ul style="list-style-type: none"> • Earn 1 credit in Algebra 2 or an equally rigorous course • Pass the Geometry EOC • Earn 1 credit in Statistics or an equally rigorous mathematics course • Pass the Biology 1 EOC* • Earn 1 credit in Chemistry or Physics • Earn 1 credit in a course equally rigorous to Chemistry or Physics • Pass the U.S. History EOC* • Earn 2 credits in the same World Language • Earn at least 1 credit in an AP, IB, AICE or a dual enrollment course <p>*A student is exempt from the Biology 1 or U.S. History EOC assessment if the student is enrolled in an AP, IB or AICE Biology 1 or U.S. History course; takes the respective AP, IB or AICE assessment; and earns the minimum score to earn college credit.</p> <p>Merit Diploma Designation</p> <ul style="list-style-type: none"> • Meet the standard high school diploma requirements • Attain one or more industry certifications from the list established (per s. 1003.492, F.S.) <p>What are the additional graduation options for students with disabilities?</p> <p>Two additional options are available only to students with disabilities. Both allow students to substitute a CTE course with related content for one credit in SLA 4, mathematics, science and social studies (excluding Algebra 1, Geometry, Biology 1 and U.S. History). The two options are as follows:</p> <ul style="list-style-type: none"> • Students with significant cognitive disabilities may earn credits via access courses and be assessed via an alternate assessment. • Students who choose the academic and employment option must earn at least 0.5 credit via paid employment. <p>What is the CAP?</p> <p>The CAP allows a student to earn high school credit if the student passes an AP examination, a College Level Examination Program (CLEP) or a statewide course assessment without enrollment in the course. The courses include:</p> <ul style="list-style-type: none"> • Algebra 1 • Geometry • Biology 1 • U.S. History 	<p>State University System (SUS)</p> <p>Admission into Florida's public universities is competitive. Prospective students should complete a rigorous course of study in high school and apply to more than one university to increase their chance for acceptance. To qualify to enter one of Florida's public universities, a first-time-in-college student must meet the following minimum requirements (credit earned by industry certification does not count for SUS admission):</p> <ul style="list-style-type: none"> • High school graduation with a standard diploma, a minimum of a 2.5 GPA, and admission test scores meeting minimum college-ready test scores per the Board of Governors (BOG) Regulation 6.008 • 16 credits of approved college preparatory academic courses per BOG Regulation 6.002 • 4 English (3 with substantial writing) • 4 Mathematics (Algebra 1 level and above) • 3 Natural Science (2 with substantial lab) • 3 Social Science • 2 World Language (sequential, in the same language or other equivalents) • 2 approved electives <p>State University System of Florida</p> <p>The Florida College System</p> <p>The 28 colleges of the Florida College System serve nearly 800,000 students. Colleges offer affordable, stackable, workforce credentials including certificate programs, associate in science degrees and associate in arts degrees, which transfer to a bachelor's degree program. Many colleges also offer workforce bachelor's degree programs in areas of high demand. All Florida College System institutions have open-door admissions for students who earned a standard high school diploma or an equivalent diploma or successfully earned college credit.</p> <p>Florida College System</p> <p>Career and Technical Colleges and Centers</p> <p>Florida also offers students 49 accredited career and technical colleges or centers throughout the state, which provide the education and certification necessary to work in a particular career or technical field. Programs are flexible for students and provide industry-specific education and training for a wide variety of occupations.</p> <p>Career and Technical Education Directors</p> <p>Where is information on financial aid located?</p> <p>The Florida Department of Education's Office of Student Financial Assistance administers a variety of postsecondary educational state-funded grants and scholarships.</p> <p>Office of Student Financial Assistance</p>
--	--

HALLWAY BEHAVIOR

Students are expected to proceed from class to class in a quiet, courteous fashion. To facilitate the movement of traffic, students should walk to the right and avoid impeding traffic by standing in groups. Common courtesies must be practiced in the hallways at all times. Please adhere to one way hallway signs.

HURRICANE/INCLEMENT WEATHER PREPAREDNESS

The School District will always consider student and staff safety of primary Importance when deciding to close school when severe weather threatens. Unless there is a clear threat of danger, the decision to close school will be made around 5:00 a.m. and announced through NBC2, WINK, ABC 7 TV morning news show and via NOAA Weather Alert Radios. Staff members should listen to local media beginning at 5:00 a.m. for the latest information pertaining to school closing during severe weather months. As early as 36 hours before a projected landfall, the District Office will provide all schools with updated information. At this point, schools are requested to bring loose objects inside. At 24 hours before a projected landfall, the latest updated information will be provided. All meetings and school events will be cancelled.

LOCKERS AND LOCKS

Due to safety concerns, we will be unable to issue lockers or locks for student this year. That includes lockers/locks for PE, Hallway and JROTC.

MAPS

Maps of the building with room numbers and designated stairwell/hallway traffic flows are located at the end of this handbook.

PARKING

Parking is available to students in designated areas after obtaining a permit. All financial obligations must be paid before a permit is issued. A permit fee of \$20.00 is charged for a full year.

PASSES

Instructional time in the classroom is critical to student success. Students are encouraged to use the restroom facilities during class changes. Passes to leave the classroom and miss instructional time will only be issued in the case of an emergency. In the case of an emergency where students must leave class, teachers will instruct students to enter a pass request in Castle and if required by administration, the teacher will call the front office to notify security personnel that the student will be leaving the classroom. All passes must be recorded in Castle. No student passes will be given during the first 10 minutes or the last 10 minutes of class.

PLEDGE OF ALLEGIANCE

At the start of each school day, the school will say the Pledge of Allegiance. Current law requires each school to post a notice in a prominent place to inform students that they have the right to not participate in the morning pledge. The bill clarifies that the student's right to not participate includes not standing or placing the right hand over his or her heart. The bill also requires the notice be published in the student handbook rather than posted at each school.

REQUEST FOR OFFICIAL TRANSCRIPTS

Students may request an official copy of their high school transcripts by completing a transcript request form in Student Services. The completed form must be turned in to the Information Specialist in office 1027.

REPORT CARDS/INTERIM REPORTS

Report cards are issued at the end of each quarter (9 weeks). Interim reports are issued once per quarter so that students are aware of their progress.

SAFETY PROTOCOLS

Masks

Facial masks covering the nose and mouth are required on the bus and in our school building unless a parent opt out form has been completed. All masks must comply with the school guidelines listed above under "dress code."

Breakfast and Lunch

Students will receive a "grab and go" breakfast each morning. Students will proceed directly to their classroom and breakfast will be eaten in the room. Students will be escorted to and from the cafeteria by their teacher for their lunch period. Lunch periods will be staggered to reduce the number of students waiting in line at any given time. Social Distancing will be enforced.

Hand Sanitizer

Stations are located throughout the school hallways and students are encouraged to use hand sanitizer frequently.

Isolation Room

Students presenting but not limited to the following COVID 19 symptoms: fever, chills, shortness of breath, difficulty breathing, new cough or loss of taste or smell will be escorted to the Isolation room to await parent pick up with a staff member.

School Bus Ramp

School bus drop off in the morning will be staggered to reduce the number of students that are walking from buses to the building. Afternoon school bus pick up will also be staggered with students being dismissed by classroom.

SCHEDULE CHANGES

Students request desired core and elective courses during the class registration period in the Spring. Students are enrolled in required core courses as necessary. All requests for schedule changes must be completed prior to the beginning of the school year. Schedule changes will be considered in cases where there is an unmet graduation requirement or if a student has completed online coursework over the summer and no longer needs the course.

SCHOOL CALENDAR

The 2021-22 Instructional Calendar is located at the end of this handbook.

SCHOOL MESSENGER

SchoolMessenger® Communicate is a program that enables administration from the District and schools to send families important messages, emergency broadcasts, attendance alerts and event reminders.

There is also a way to receive text messages, however under a rule by the Federal Communications Commission, you must opt in for that service. The process is easy and only takes a few seconds to complete. Simply text any one of these words **subscribe**, **optin** or **yes** to the number 67587.

You will know you were successful if you receive the following reply message:

You are registered 4 School Messenger notifications. Reply STOP to cancel, HELP for help. Msg&data rates may apply. Msg freq. varies. schoolmessenger.com/txt

You will want to repeat the opt-in process for any wireless numbers that you wish to include. Please note, although the district does not charge you for this service, it does not pay for text or phone message charges that may be incurred by you for sending or receiving text messages or receiving phone calls. Check with your wireless carrier for possible charges.

In addition to performing the opt-in process above, you will want to ensure that the district has your wireless number(s) in our student information database. If you have not already provided that information to your school, please contact them directly.

Families may sign up for a free account at go.schoolmessenger.com to set communication preferences for calls and emails.

SEARCH AND SEIZURE

If at any time there is reason to believe that a student is concealing stolen or illegal property, alcoholic beverages, tobacco or tobacco products, illegal drugs, substances, drug paraphernalia and/or any weapons, a school administrator has the right to search the student as well as the student's locker, vehicle, or personal property. In addition, school premises are subject to search by trained animals. (Florida Statute #232.256)

SEMESTER EXAMS/EARLY DISMISSAL DAYS

Exams are only given on scheduled dates. Failure to take a semester exam will result in a grade of "0" until the exam is completed. Requests to take the exam at a later date must be submitted to the teacher or administration.

SEMESTER ONE EXAMS MIDTERMS	SEMESTER TWO EXAMS FINALS
January 4, 5, 6, 7	May 27, 31* June 1*, 2*

*Early Dismissal Dates

SENIOR OPTION

The Senior Option is a scheduling option that the School District considers on a year-to-year basis for senior students who are on track for graduation. When approved, seniors who meet the criteria set forth by the district may be scheduled for fewer classes during the school day. Senior Option requires parent consent, and students must provide their own transportation.

SIGN-OUT PROCEDURES

In the case of an emergency that may require a student to leave school prior to the regular dismissal time, the student must sign out in the main office with a note from a parent or guardian that has been verified by administration or office staff. **The school will call a parent to confirm a note requesting the student be allowed to sign out.**

STUDENT IDENTIFICATION CARDS

All students receive a picture identification card with their I.D. number after school pictures are taken. This card must be presented at lunch and may be requested to enter school activities or leave campus early for senior option or OJT. The initial card is free. When a card is lost a new one may be purchased in Student Services for a cost of \$5.00.

STUDENT SERVICES DEPARTMENT

The Student Services Department offers a wide range of counseling services including testing, counseling, scheduling, registration, and dissemination of information. The department also offers an up-to-date selection of college catalogs and reference material on financial aid and scholarships. The school social workers work with attendance related issues and school placement based on residence. Students are expected to email their counselor as needed for academic and/or personal concerns. Please note, some requests can be resolved without a meeting and some academic concerns will be addressed via email.

STUDENT SERVICES DEPARTMENT 2020-2021

Mr. Michael Kelley: All 9th Graders and CTE Certifications/Support

Mrs. Janet Cocchieri: All 10th Graders

Mrs. Jennifer Chalker, All 11th Graders and Dual Enrollment

Mrs. Natalee Davis: All 12th Graders

Mrs. Carolyn Hutto: AVID, College and Career Preparations; Scholarships; FAFSA

TOBACCO AND VAPOR USE ON CAMPUS

Possession, use, distribution or sale of tobacco products (including E-Cigarettes and Vapes) are prohibited on Lee District School's property. This includes smokeless tobacco, such as dip and chew. Students in possession or caught using tobacco may be referred to the LCSO Deputy for a citation and fine. Additionally, possession or use of THC pens is a Level III offense and may result in a felony arrest.



PERSONAL | PASSIONATE
PROGRESSIVE

The School District of Lee County

2021 -2022

Instructional Calendar

July 2021							January 2022						
S	M	T	W	T	F	S	S	M	T	W	T	F	S
				1	2	3							1
4	5	6	7	8	9	10	2	3	4	5	6	7	8
11	12	13	14	15	16	17	9	10	11	12	13	14	15
18	19	20	21	22	23	24	16	17	18	19	20	21	22
25	26	27	28	29	30	31	23	24	25	26	27	28	29
							30	31					
August 2021							February 2022						
S	M	T	W	T	F	S	S	M	T	W	T	F	S
1	2	3	4	5	6	7			1	2	3	4	5
8	9	10	11	12	13	14	6	7	8	9	10	11	12
15	16	17	18	19	20	21	13	14	15	16	17	18	19
22	23	24	25	26	27	28	20	21	22	23	24	25	26
29	30	31					27	28					
September 2021							March 2022						
S	M	T	W	T	F	S	S	M	T	W	T	F	S
				1	2	3			1	2	3	4	5
5	6	7	8	9	10	11	6	7	8	9	10	11	12
12	13	14	15	16	17	18	13	14	15	16	17	18	19
19	20	21	22	23	24	25	20	21	22	23	24	25	26
26	27	28	29	30			27	28	29	30	31		
October 2021							April 2022						
S	M	T	W	T	F	S	S	M	T	W	T	F	S
					1	2						1	2
3	4	5	6	7	8	9	3	4	5	6	7	8	9
10	11	12	13	14	15	16	10	11	12	13	14	15	16
17	18	19	20	21	22	23	17	18	19	20	21	22	23
24	25	26	27	28	29	30	24	25	26	27	28	29	30
31													
November 2021							May 2022						
S	M	T	W	T	F	S	S	M	T	W	T	F	S
1	2	3	4	5	6		1	2	3	4	5	6	7
7	8	9	10	11	12	13	8	9	10	11	12	13	14
14	15	16	17	18	19	20	15	16	17	18	19	20	21
21	22	23	24	25	26	27	22	23	24	25	26	27	28
28	29	30					29	30	31				
December 2021							June 2022						
S	M	T	W	T	F	S	S	M	T	W	T	F	S
				1	2	3				1	2	3	4
5	6	7	8	9	10	11	5	6	7	8	9	10	11
12	13	14	15	16	17	18	12	13	14	15	16	17	18
19	20	21	22	23	24	25	19	20	21	22	23	24	25
26	27	28	29	30	31		26	27	28	29	30		

- Holiday – Schools Closed
- Professional Duty Day – No School For Students
- Preschool Days – No School For Students
- First and Last Student Day
- Early Dismissal Days – Students
- Hurricane Make-Up Day

Special Notes

- *All Jewish Holidays begin at sundown the day before they are listed*

Board Approved 11/17/2020

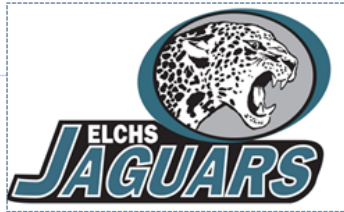

104 = Literacy Coach
 105 = Destination Graduation
 105A =
 105B = Itinerants

1st Floor

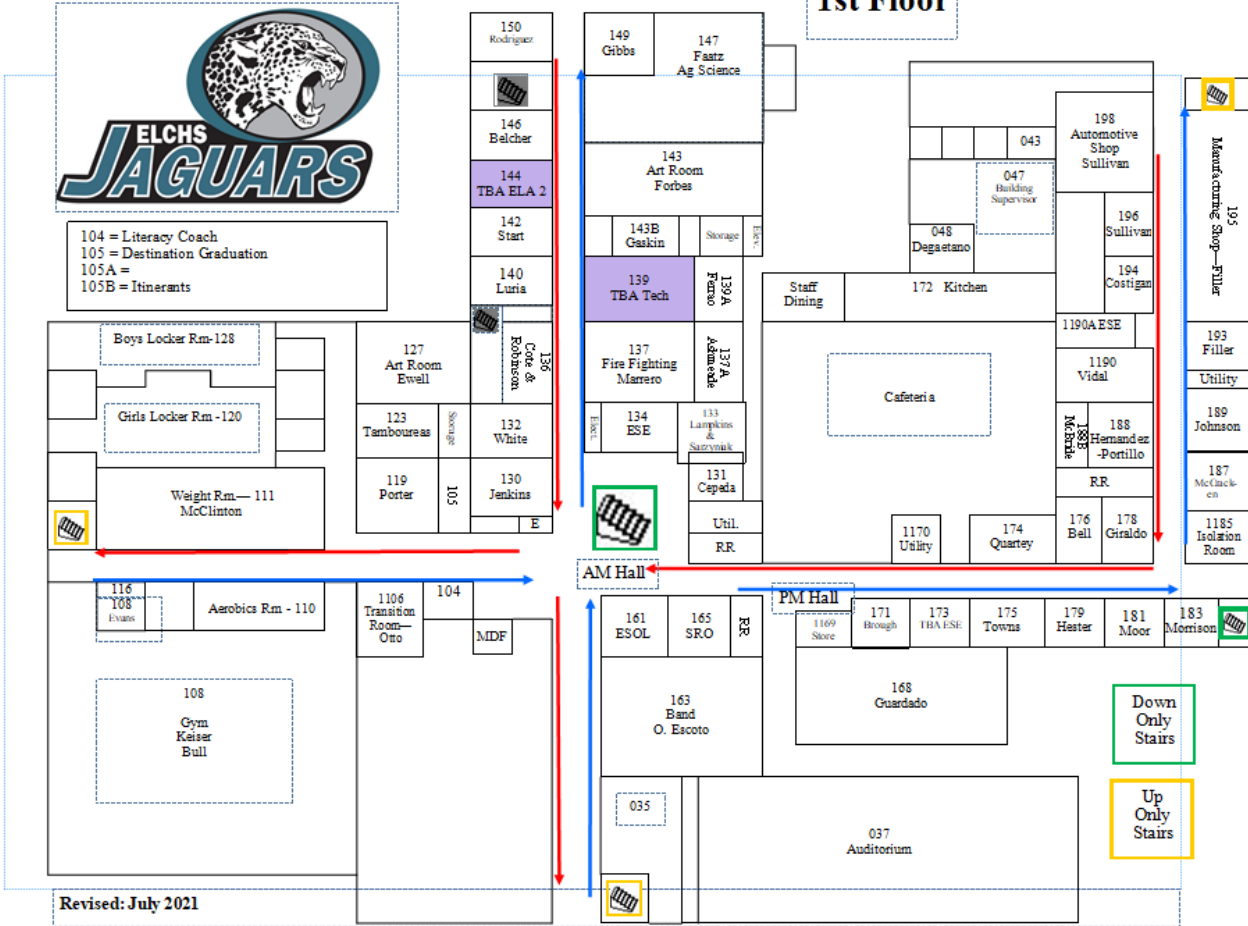

Revised: July 2021

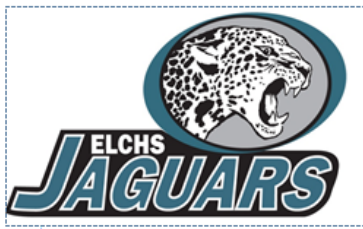

2nd Floor

